



Quick Start Guide

Version 1.0.0



Packing List



Device*1



QSG*1



Power Adapter*1



Quick Installation Board*1



Installation Position Map*1



Screw Package*1



USB*1

Product Appearance

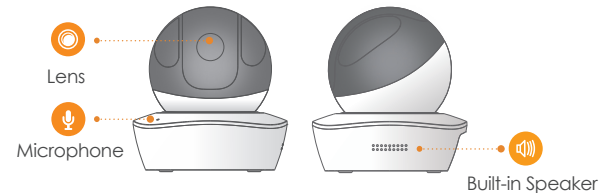
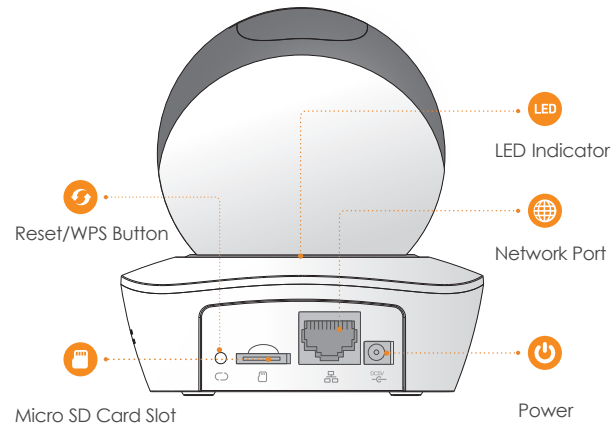

The following table shows more information about status of indicator light

| Indicator Light Status | Device Status |
|------------------------|--|
| Spinning red | <ul style="list-style-type: none">BootingDevice malfunctionFailed to boot up |
| Spinning green | <ul style="list-style-type: none">Booting completedWaiting for Wi-Fi configuration |
| Flashing yellow | <ul style="list-style-type: none">WiFi connection processDevice has been configured with WiFi, but it failed to work normally |
| Flashing green | WPS pairing |
| Blue light stably on | <ul style="list-style-type: none">Wi-Fi connection succeededOperate normally |
| Flashing blue | Device upgrade |
| Flashing red | SD card malfunction |

Note:

To reset, long press for 10 seconds till the light is off; to enable WPS, just press the button.

Operation by Imou App

Step 1

Power on your camera with power adapter.

Step 2

Connect your smartphone to your Wi-Fi network, scan the QR on the packing box to download and install Imou App.



Step 3

Run Imou App, and register account for first use.

Step 4

Follow the steps below to add your camera .

Device Installation

Note:

Before installation, please make sure the installation environments can at least support 3x weight of the device.

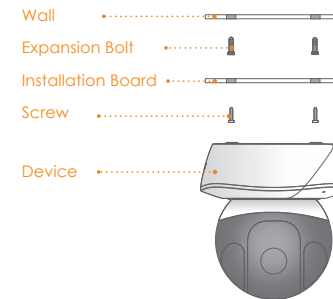

To install the device, do the following.

Step1 Drill holes on the wall and install the expansion bolts into the drilled holes.

Step2 Fix the installation board with screws onto the wall.

Step3 Spin the device to get locked onto the installation board.

Note:

-If you have more cameras, please follow step 4 to add them one by one.

-If you want to change the Wi-Fi signal, please reset the camera to factory default and repeat step 4 to add the camera.

Disclaimer

- This quick start guide is for reference only. Minor difference might be found in user interface.
- All the design and software here are subject to change without prior written notice.
- All trademarks and registered trademarks mentioned are the properties of their respective owners.
- Please visit our website or contact your local service engineer for more information.
- If there is any uncertainty or controversy, please refer to our final explanation.