

ICZB-RM11S Zigbee Remote control



Important: Read all instructions prior to installation.

Features

- Compatible with certified Zigbee products like Philips Hue and IKEA Home smart*
- Supports 4 groups for binding max. 30 lighting devices
- Touchlink commissioning support
- Battery powered with low power consumption
- Transmission range up to 30 meter
- Radio Frequency : 2.4GHz
- Waterproof grade: IP20

*Check www.icasa.io/support for the most recent compatibility overview.

Safety & Warnings

- Contains a lithium battery that shall be stored and disposed properly
- Keep battery away from small children
- DO NOT expose the device to moisture

Instructions

First add the remote to your gateway. Next pair all lighting devices to the desired groups individually.

Before the first use, please remove the protective battery separator.

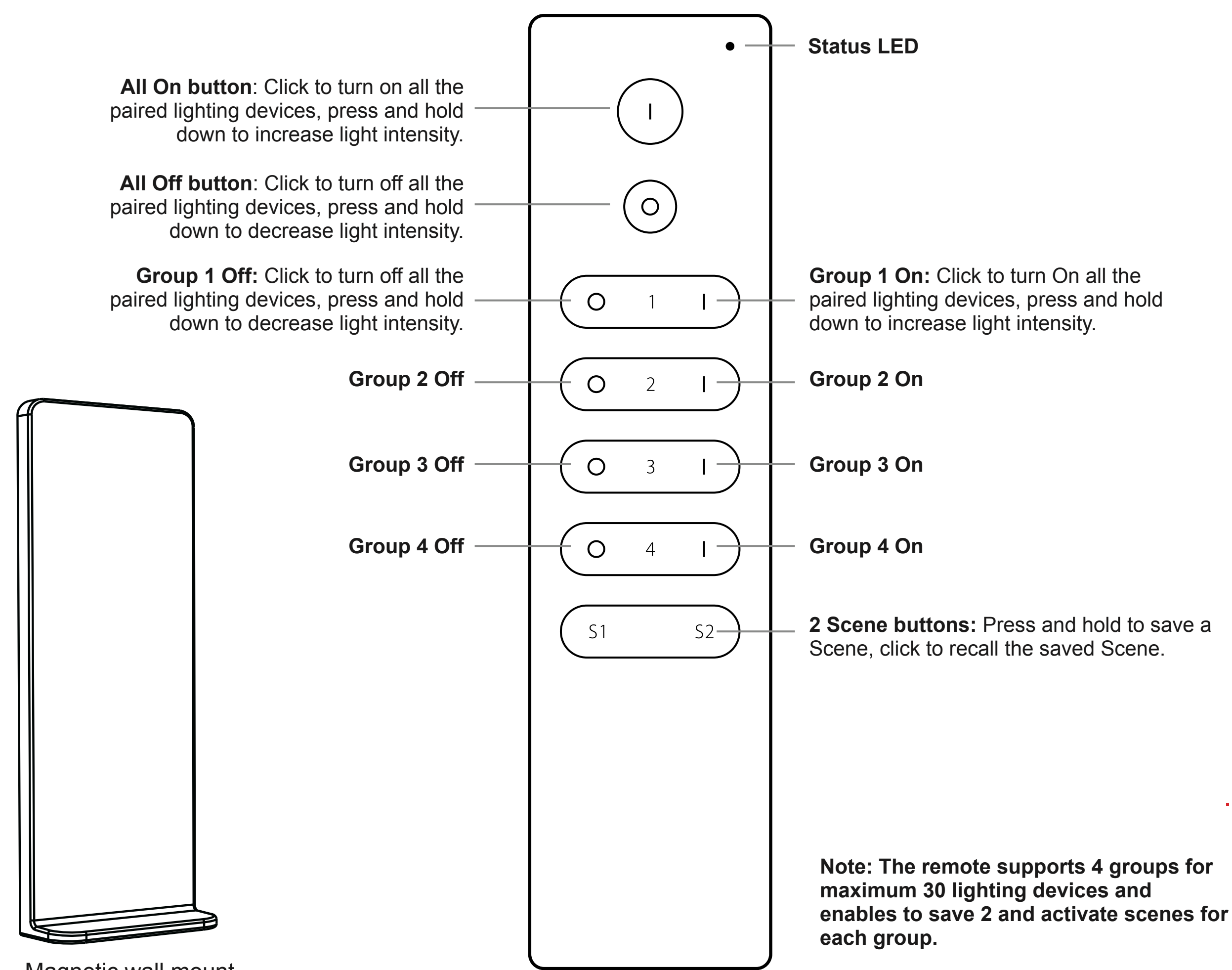
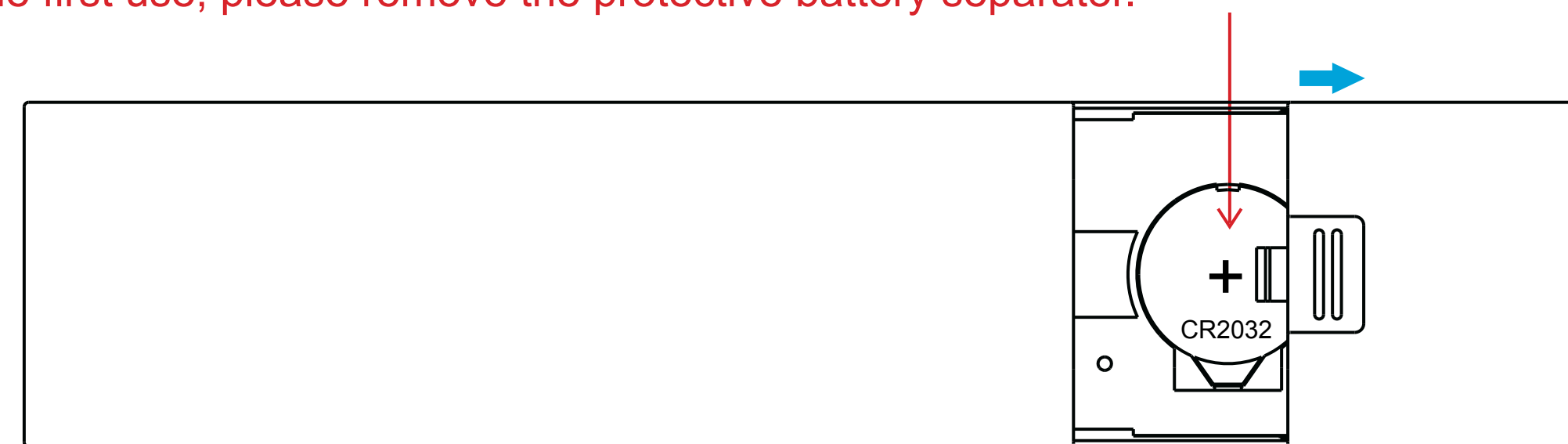

Magnetic wall mount

Add the remote to a Zigbee gateway

- 1) By factory default, the remote is not paired to a gateway. If you press any button on the remote, the Status LED will not blink. If the Status LED blinks follow the "Factory reset the remote" procedure first.
- 2) In your gateway App, choose to add an accessory device. Please refer to the manual of your gateway.

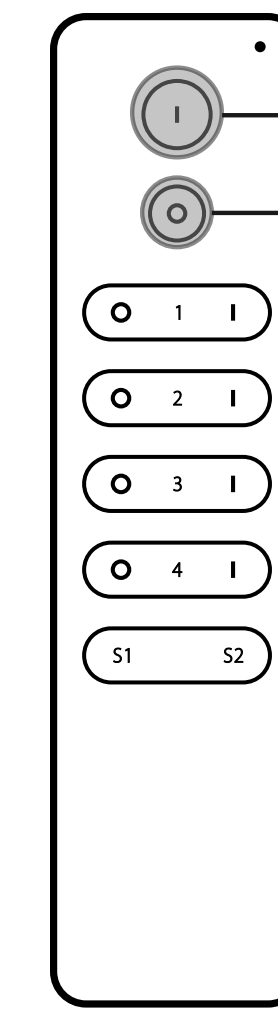

- 3) Press and hold until the Status LED turns on.
- 4) Immediately short press. The LED indicator will turn on/off every second during the process. When the pairing is successful the Status LED will blink 5 times quickly.

Note: Some gateways, like Philips Hue, will not show the remote in the App menu.

Pair the remote to a Zigbee lighting device (Touchlink)

- 1) Initiate TouchLink Commissioning on your lighting device. Please refer to the manual of your lighting device.
- 3) Short press the **On button** of the **group 1/2/3/4** you would like to add the lighting device to.
- 5) then immediately click the **Group 1 Off** button to start the TouchLink proces. If the pairing is successfully the Status LED will blink 6 times. You can now control the light from the selected group.

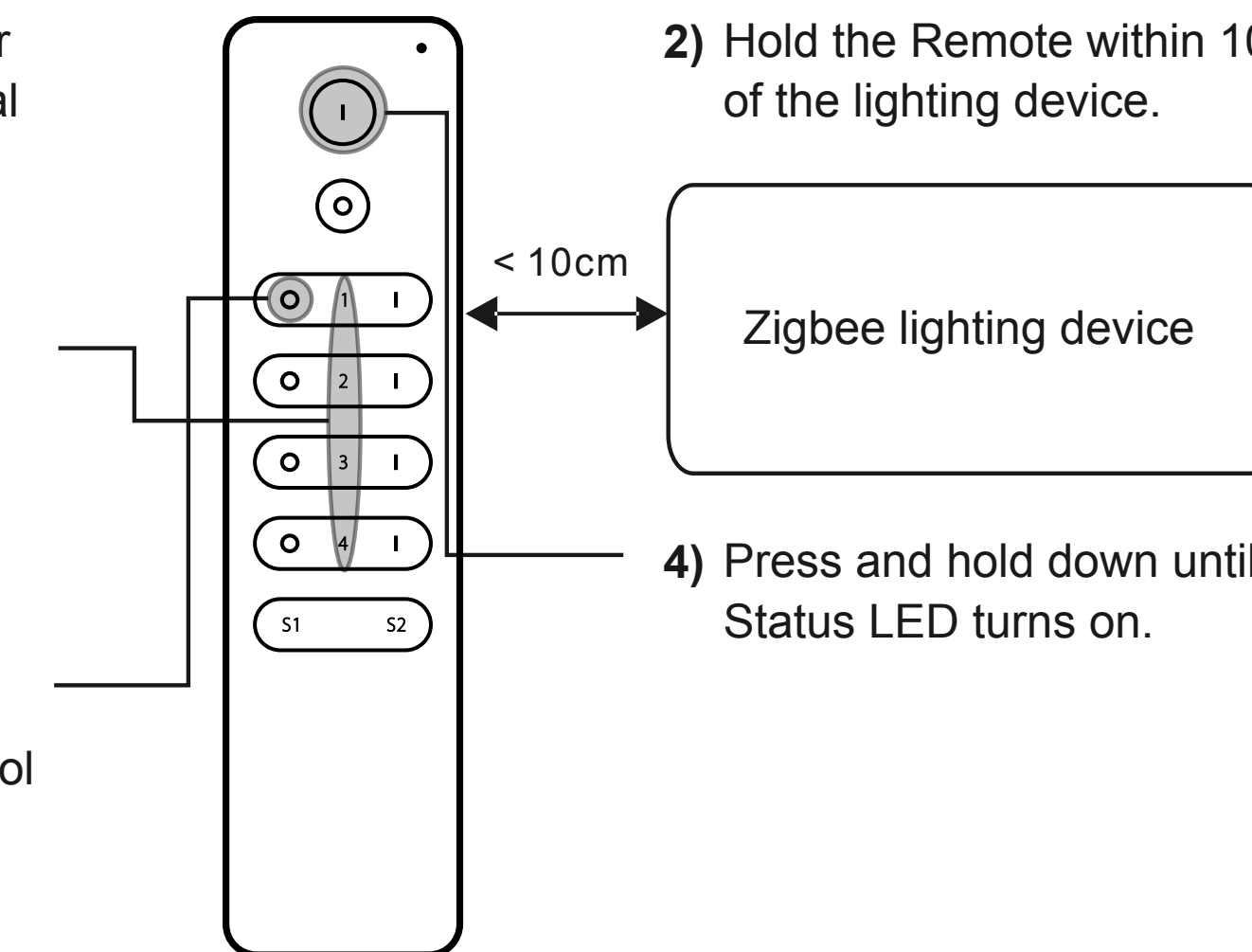

- 2) Hold the Remote within 10cm of the lighting device.
- 4) Press and hold down until the Status LED turns on.

Remove Touchlink paired Zigbee lighting device

- 1) Initiate TouchLink Commissioning on your lighting device. Please refer to the manual of your lighting device.
- 3) Short press the **On button** of the **group 1/2/3/4** you would like to add the lighting device to.
- 5) Then immediately click the **Group 1 Off** button **twice** to start the TouchLink removal proces. When successful the Status LED will blink 6 times.

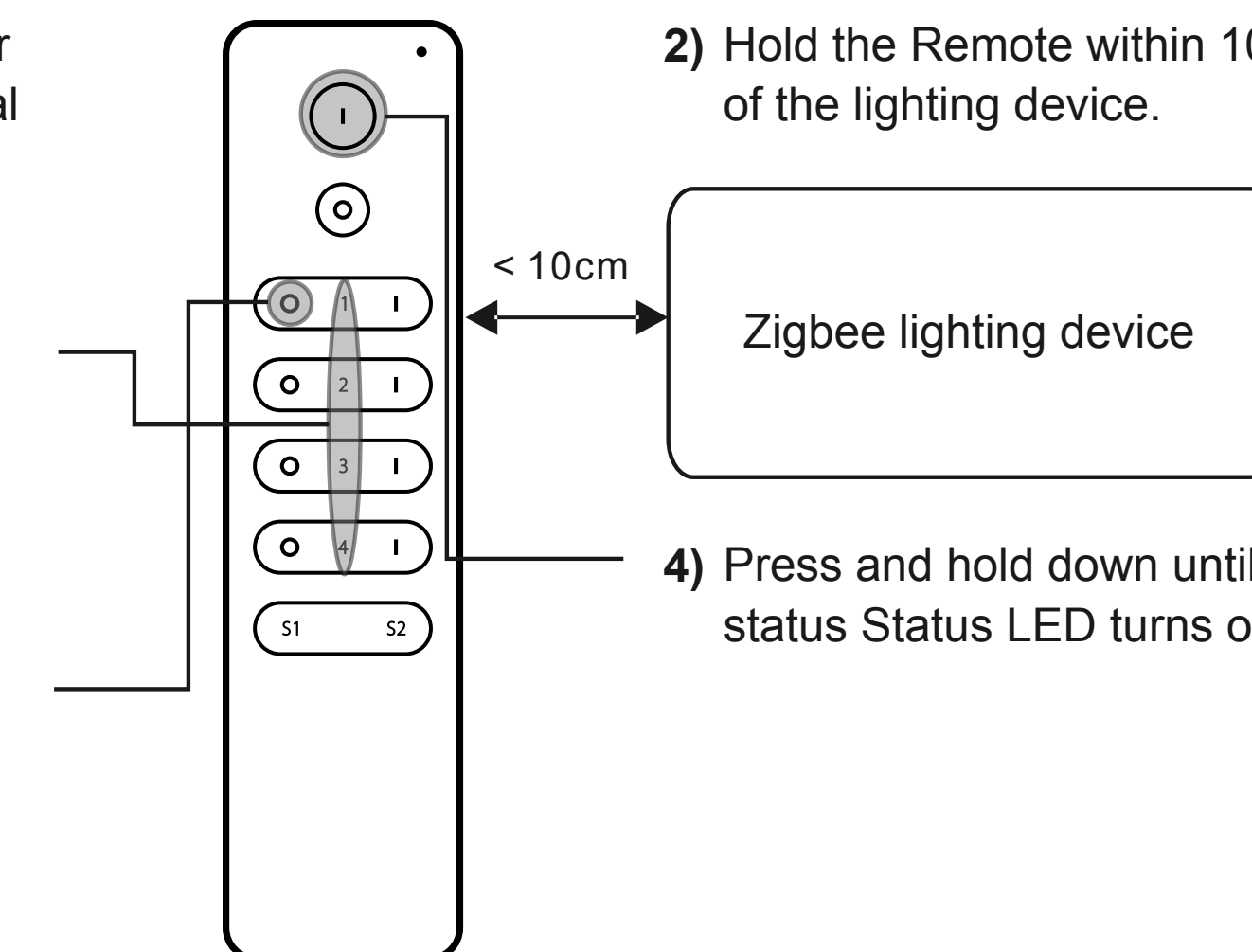

- 2) Hold the Remote within 10cm of the lighting device.
- 4) Press and hold down until the status Status LED turns on.

Factory reset the remote

- 1) Press and hold down until the Status LED turns on.

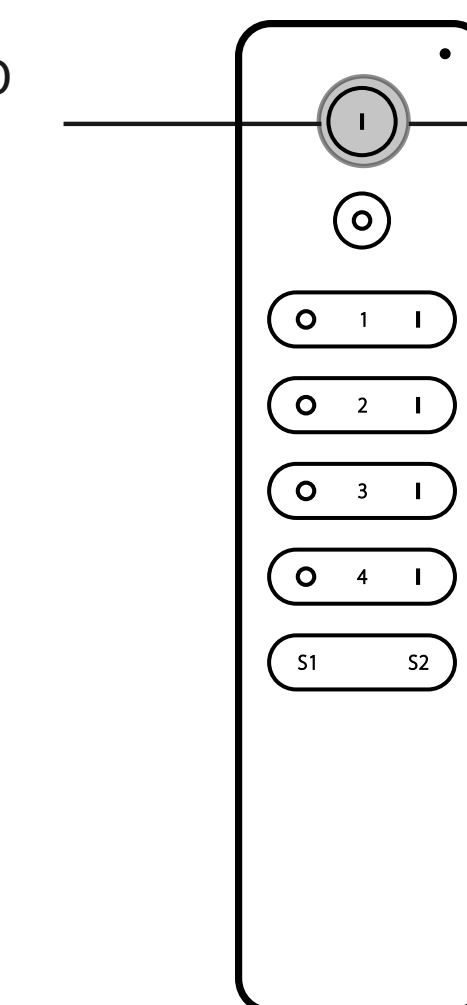

- 2) Immediately short press 5 times, the Status LED flashes 3 times to indicate a successful reset.